

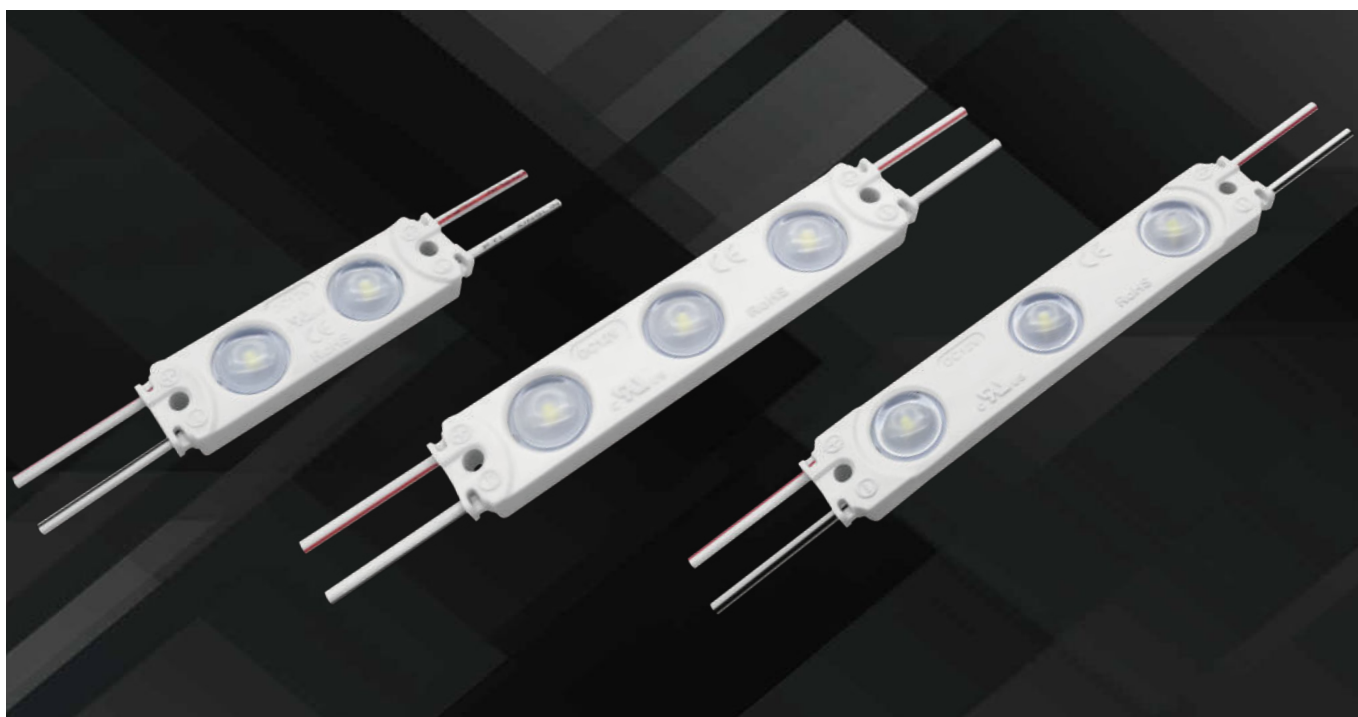

Soluții pentru publicitate și decor

# BASIC LED MODULES



## Features

- Powered by high output 2835 LED.
- Constant voltage.
- Clear 160° optic lens.
- 20 pcs per string.
- CE, RoHS, UL, TUV, BIS, CB and LM-80 certified.

## Application

- Apply to 3–15 cm depth signs at airports, metros, banks, buildings and shopping malls, etc.

## Parameters

Items	Parameters		
Part Number	ZE02QAC	ZE03QAC	ZE03QAD
CCT (K)	7000K	7000K	7000K
Beaming Angle (°)	160°	160°	160°
CRI (Ra)	≥75	≥75	≥75
Luminous Flux (lm)	70	100	145
Voltage (V)	DC12	DC12	DC12
Power (W)	0.72	1	1.5
Driving Method	Constant Voltage	Constant Voltage	Constant Voltage
Dimension (mm)	50.5*15*7.2	74.5*15*7.2	83*15*7.2
Working Tem. (°C)	-25 ~ +60	-25 ~ +60	-25 ~ +60
Storage Tem. (°C)	-25 ~ +70	-25 ~ +70	-25 ~ +70
Protection Grade	IP65	IP65	IP65

## Dimension

Unit: mm

ZE02QAC

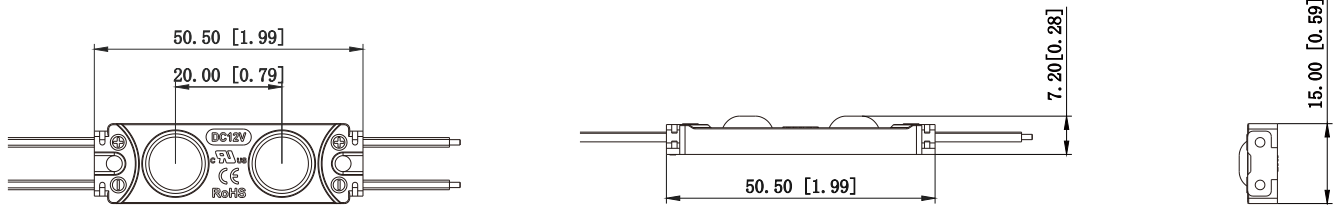

ZE03QAC

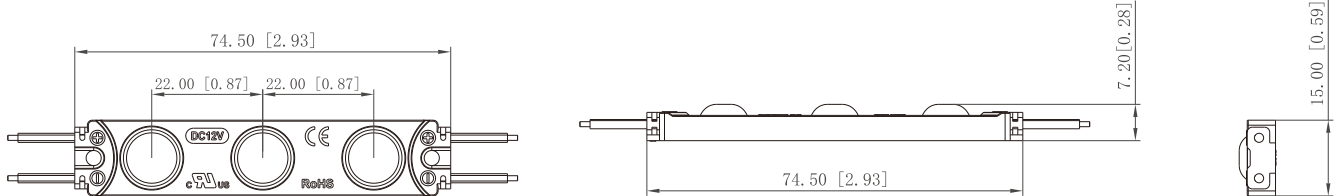

ZE03QAD

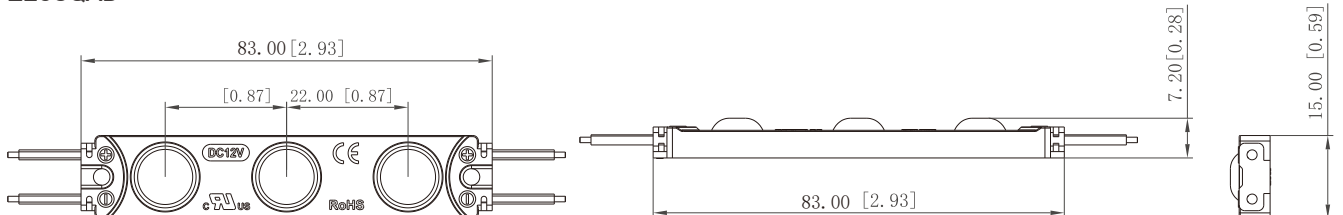

## Beaming Angle

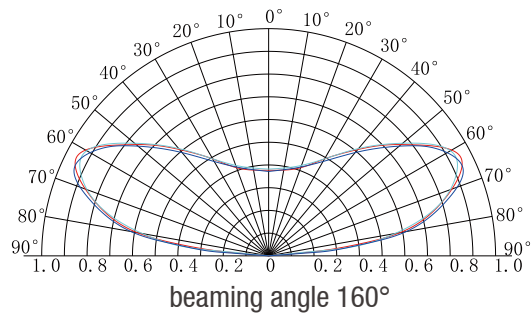

## Reference Scheme

Part Number	Depth(mm)	Distance(mm)	Density(pcs/m <sup>2</sup> )	Illumination(lux)
ZE02QAC	Dz=80	Dx=100 Dy=80	125	1600–1800
	Dz=100	Dx=120 Dy=100	83	900–1100
	Dz=120	Dx=140 Dy=120	60	600–800
	Dz=150	Dx=170 Dy=150	39	500–600

Part Number	Depth(mm)	Distance(mm)	Density(pcs/m <sup>2</sup> )	Illumination(lux)
ZE03QAC	Dz=80	Dx=120 Dy=80	104	2000–2500
	Dz=100	Dx=140 Dy=100	71	1300–1600
	Dz=120	Dx=160 Dy=120	52	1000–1200
	Dz=150	Dx=190 Dy=150	36	700–900

Part Number	Depth(mm)	Distance(mm)	Density(pcs/m <sup>2</sup> )	Illumination(lux)
ZE03QAD	Dz=80	Dx=120 Dy=80	104	2000–2500
	Dz=100	Dx=140 Dy=100	71	1300–1600
	Dz=120	Dx=160 Dy=120	52	1000–1200
	Dz=150	Dx=190 Dy=150	36	700–900

### Remark :

01. The transmittance of the Acrylic was 56%.
02. The above data is for reference only.

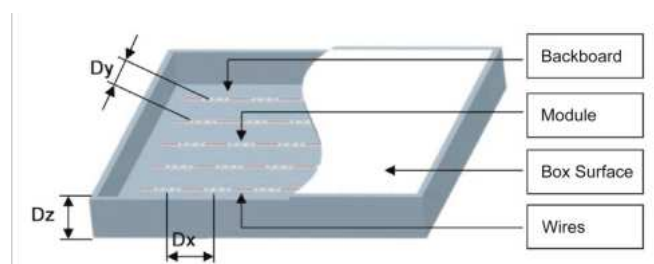

## Wire Connection

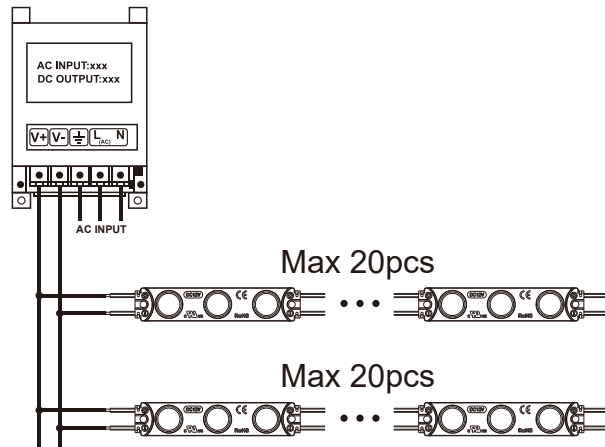

## Packing

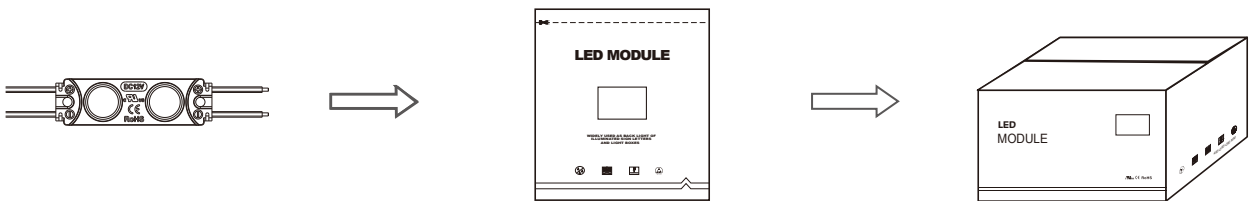

ZE02QAC 20 pcs per string  
ZE03QAC 20 pcs per string  
ZE03QAD 20 pcs per string

100 pcs in an anti-static bag  
100 pcs in an anti-static bag  
100 pcs in an anti-static bag

1500 pcs per carton  
1500 pcs per carton  
1000 pcs per carton

## Packing Specification

- Antistatic bag adopted
- Packing information

Part Number	ZE02QAC	ZE03QAC	ZE03QAD
Carton Dimension(mm)	490*450*220	490*450*220	490*450*220
Bags Per Carton	15	15	10
Quantity Per Carton(pcs)	1500	1500	1000
Net Weight(kg)	12(1±10%)	17(1±10%)	13(1±10%)
Gross Weight(kg)	13(1±10%)	18(1±10%)	14(1±10%)

Due to the packing manner difference, please adhere to the original products in case of discrepancy found between the picture and actual product.

## Self-provided tools & material

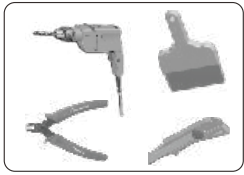

Dust brush, cutter, pencil, wire stripper, and drill

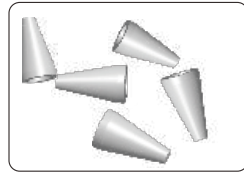

Wire Connector ( Standard)

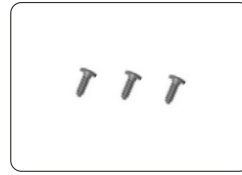

Screw

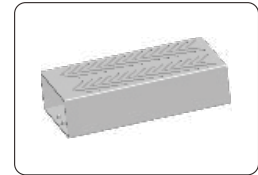

Power Supply

## Installation Guidance

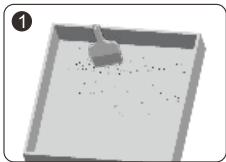

- Clean inside the light box.

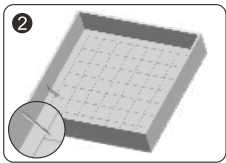

- Determine the appropriate layout.

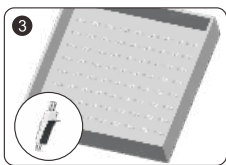

- Peel tape backing and stick modules into place.

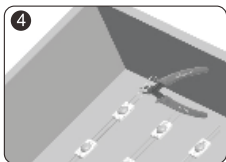

- Remove the unneeded modules.
- ⚠ Note: Cut in the middle position of the wires between modules.

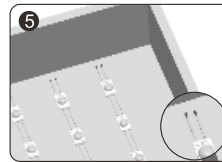

- Strip the end wire for 10mm and cap with the wire connector. Waterproof and anti-corrosion must be done on the connectors.

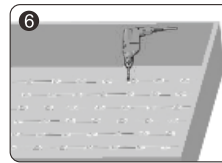

- Locate modules in the optimal position and secure with screws or neutral glass cement, which should be applied at the edge of the modules.

⚠ Note: Avoid breaking the module and wire when fixing with a drill.

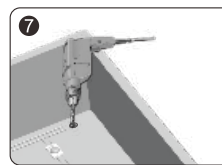

- Drill a hole for connecting power cable. Fixation and protection for the cable must be done on the hole.

⚠ Note: Avoid breaking the light box in drilling the hole.

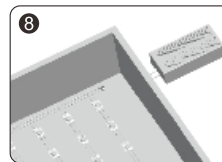

- Connect to the power cable and make sure that the polarity for connection is correct.

⚠ Note: Red wire is positive and black wire is negative.

---

## Instructions

01. Disassembling or modifying the product is not allowed.
02. Installation with power on is not allowed.
03. Any organic solvent chemical is not allowed.
04. Acidic or alkaline adhesive is not allowed when install, neutral glass cement could be used for installation purpose, make it drying in open environment for four hours.
05. Isolation and corrosion prevention on all wiring points and wire ends.
06. Make sure the power wire is thick enough and ensure the voltage and connections are connected correctly before power on.
07. This product should be used in a sign, do not expose it in opening site.
08. Installation, maintaining should be done by professional staff.
09. 20 pcs in a serial connection maximum.
10. The power wire between power supply and module should be less than two meters to keep the same brightness on all parts.
11. Initial location with 3M tape, then secure with screws.

## Declaration

01. Warranty: 3 years.
02. In order to ensure the safety, the broken wires need to be replaced by the manufacturer or the service agent, or by the staff with the similar qualification.
03. The given data in the specification was based on the laboratory testing, there may be discrepancy found in the actual products.
04. The given drawings in the specification are only for reference, there may be discrepancy found in the actual products.
05. The products are subject to change without prior notification.

**BUCUREȘTI:**

[bucuresti@verla.ro](mailto:bucuresti@verla.ro)

Tel: +4 0729 016 484

**CLUJ-NAPOCA**

[cluj@verla.ro](mailto:cluj@verla.ro)

Tel: +4 0721 242 216

**IAȘI**

[iasi@verla.ro](mailto:iasi@verla.ro)

Tel: +4 0745 381 525